

MABI 16-4Z EVO

Rohrblitz

MABI®

PATENT



Compact decoiler & pipework-fabrication-unit



Up to 8 tubes per minute



914 mm to 1250 mm sheet width

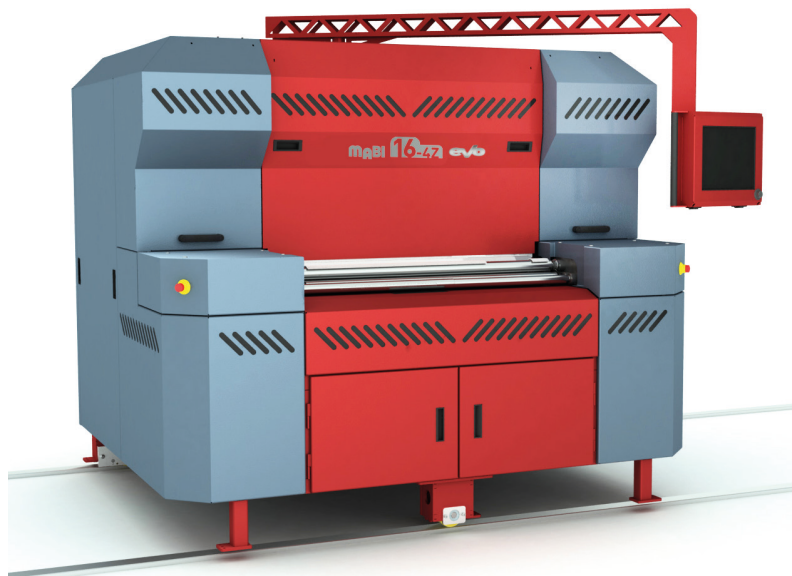

- Punching (fast lifting) for standard pipes
- Rounding unit 914 mm - 1250mm
- Automatical printing system
- Coil engine in combination with MABI 6C
- Fabrication of straight insulation pipes (up to 8 tubes per minute) ready for fitting / 480 tubes per hour
- Conic punching (straight blanks and pipes) for offset swages (50 mm from the end)
- Router for ADSL/DSL (access on the part of the customer)
- Automatic correction of beading addition

The fastest, most versatile and compact decoiler & pipework-fabrication-unit from MABI

In a very small space: straightening, cutting, punching, beading, rounding and beads for straight sheet metal blanks and ready-to-install pipes. Including 50 mm offset bead, processing of material widths 914 mm up to 1250 mm without surcharge and much more.

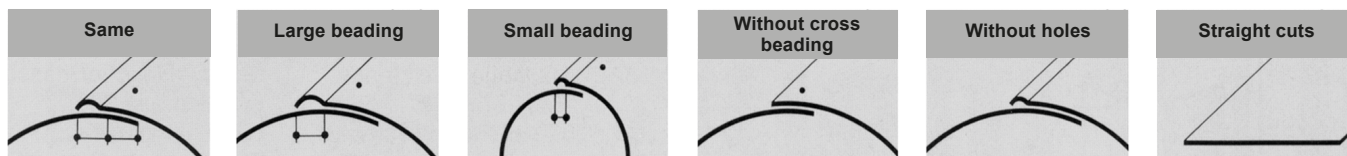

Technical Information

Dimensions

Length	2310 mm
Width	2250 mm
Height	2200 mm
Weight	2330 kg
Power connection	400VAC/50Hz3L+N+PE 32A CEE Industry-plug socket
Plug socket secured with protective switch	LSL Fuse 32A Type C
Maximum capacity	9KW
Consumption	ca. 250l/Min.
Output pressure	10 Bar
Storage tank	min. 250 l

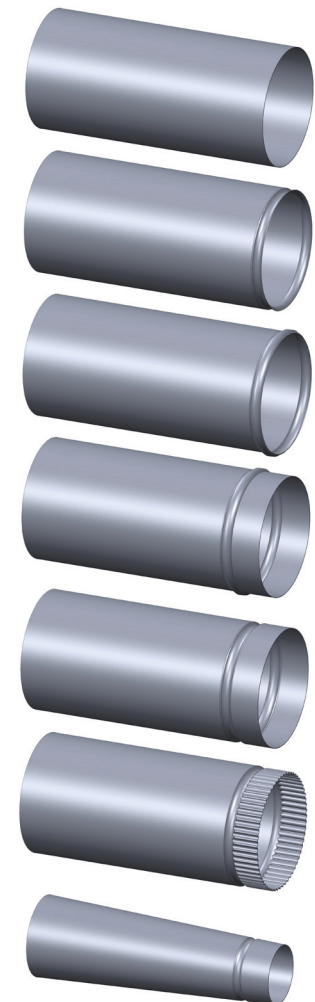
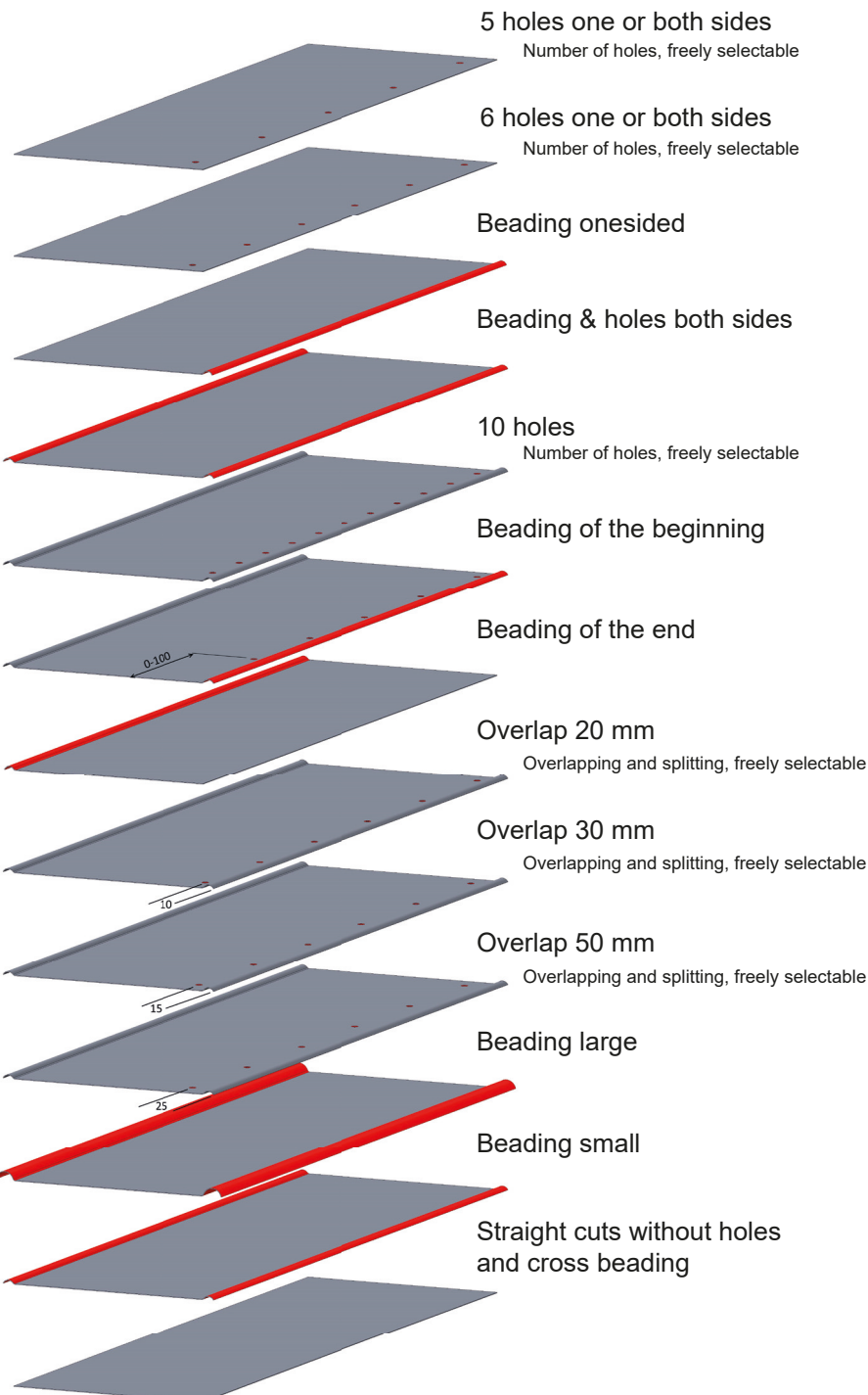
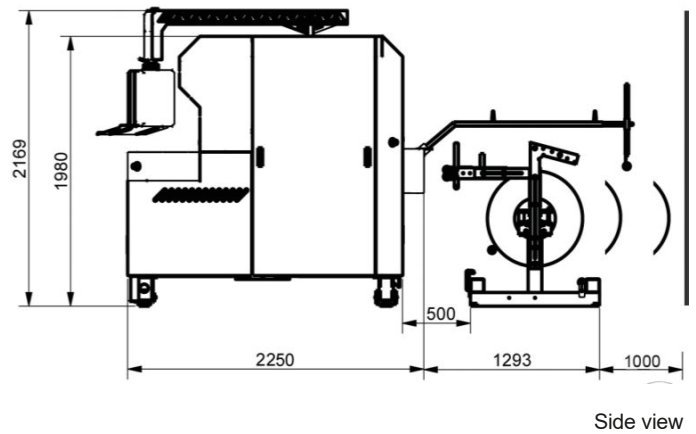

Including conical punching and 50 mm offset bead

Subject to technical modifications without notice

